

15 NORTHUMBERLAND STREET NE LANE, EDINBURGH



FOR LEASE: c.1,900 sqft Fully Refurbished, Open Plan Office Space with Car Parking

Key Features:

- Comprehensive refurbishment commencing soon with specification to be confirmed (interested tenants could influence specification with early engagement)
- Current rateable value - £40,400
- No service charge
- 7 demised car parking spaces located within the adjacent car park
- Peaceful location off Northumberland Street in the prestigious New Town, close to a range of excellent local amenities and a short walk from the city centre

Indicative Floor Plan:

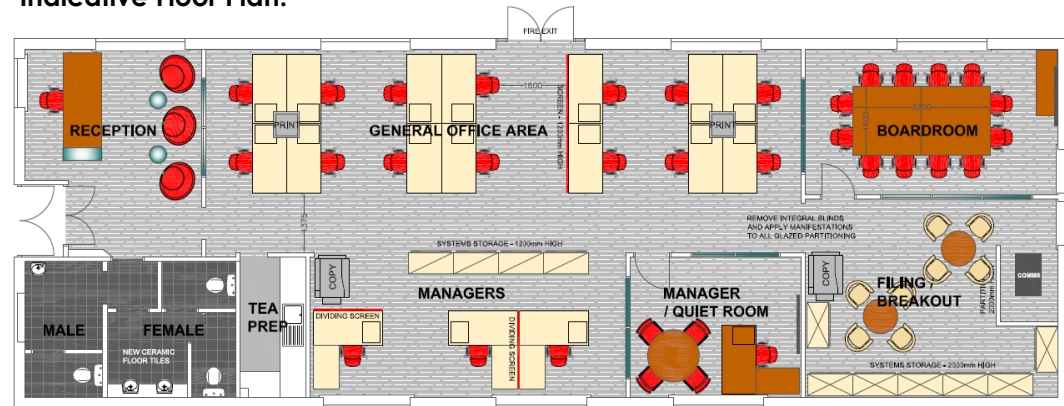

Viewing & Further Information:



James Metcalfe
james@cuthbertwhite.com
07786 623 282

Chris Cuthbert
chris@cuthbertwhite.com
07989 395 165

