



# Waterloo Street

Glasgow G2 6AY

**Partially  
Fitted**

**Open Plan  
2nd Floor  
Office  
Located in  
the Core City  
Centre**

**7,334 sq ft (681.31 sq m)**

**Directly opposite the West  
entrance into Glasgow  
Central Train Station**



## Location

Glasgow is the largest city in Scotland with a population of around 660,000 people and a wider shopping catchment of 2 million. The premises occupy a prominent position on the south side of Waterloo Street, in the heart of the city centre.

Waterloo Street is one of the main traffic routes out of the city centre and the premises benefit from its close proximity to Glasgow Central Station as well as many city centre offices which generate considerable passing footfall. Nearby amenities include Caffè Nero, The Smokin' Fox, Rhoderick Dhu and Pure Gym.

## Waterloo Street

Glasgow G2 6AY



## Accommodation

Floor	Sq Ft	Sq M
Second	7,334	681.31



## Floor Plan

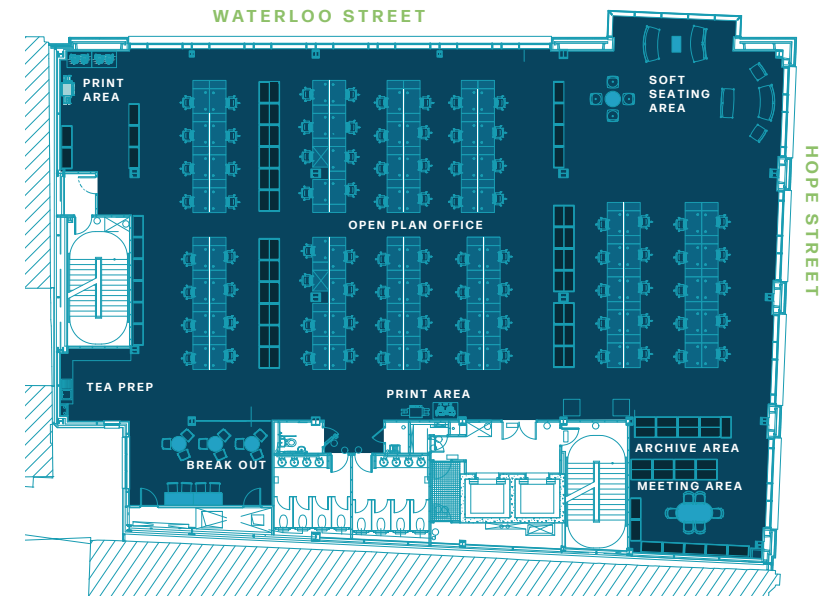



# Waterloo Street

Glasgow G2 6AY

## Specification

The second floor is available by way of a sublease (potential to agree a long term lease agreement), the space comes with the benefit of the following specification:



Tea Prep / Fully Fitted Kitchen & Break out



Raised access floor



Extensive basement showers and changing facilities



Male, female and accessible toilets on each floor



86 desks with scope to increase to 120



Furniture and partial fit out available to tenants



24 hour manned reception



2 - 10 person passenger lifts



2 secure car parking spaces



Suspended ceilings



3 x free standing meeting room pods



VRF Air conditioning

## Amenities

- |                        |                         |
|------------------------|-------------------------|
| 01 PureGym             | 09 Motel One            |
| 02 The Smokin' Fox     | 10 Alston Bar & Beef    |
| 03 Caffè Nero          | 11 Gordon Street Coffee |
| 04 Tesco               | 12 Sainsbury's          |
| 05 Barburrito          | 13 Slug & Lettuce       |
| 06 Grand Central Hotel | 14 Blue Dog             |
| 07 Boots               | 15 Gin71                |
| 08 Radisson Blu Hotel  | 16 Everyman Cinema      |

# Waterloo Street

## Rent

£27.50 per sq ft.

## Rates

£8.20 per sq ft.

## Service Charge

£9.50 per sq ft  
(including utilities).

## Car Parking

£2,500 per  
space per annum.

## Further Information



0141 221 9191  
**Knight Frank**



**0131 202 1880**  
www.cuthbertwhite.com

Sarah Hagen  
0141 566 6987  
sarah.hagen@knightfrank.com

Chris Cuthbert  
07989 395 165  
chris@cuthbertwhite.com

Knight Frank LLP / Cuthbert White hereby gives notice that the information provided (either for itself, for any joint agents or for the vendors lessors of this property whose agent Knight Frank LLP / Cuthbert White is in this brochure is provided on the following conditions: 1. The particulars are set out as a general outline only, for the guidance of intending purchasers and/or lessees and do not constitute an offer or contract, or part of an offer or contract. 2. All descriptions, dimensions and references to this property's condition and any necessary permission for use and occupation, and any other relevant details, are given in good faith and are believed to be correct. However, any intending purchasers or tenants should not rely on them as statements or representations of fact but satisfy themselves of their correctness by inspection or otherwise. 3. No person in the employment of Knight Frank LLP / Cuthbert White, or any joint agents, has any authority to make or give any representation or warranty whatsoever in relation to the property or properties in this brochure. 4. All prices quoted are exclusive of VAT. 5. Knight Frank LLP / Cuthbert White shall have no liability whatsoever in relation to any documents contained within the brochure or any elements of the brochure which were prepared solely by third parties, and not by Knight Frank LLP / Cuthbert White. March 2021

